

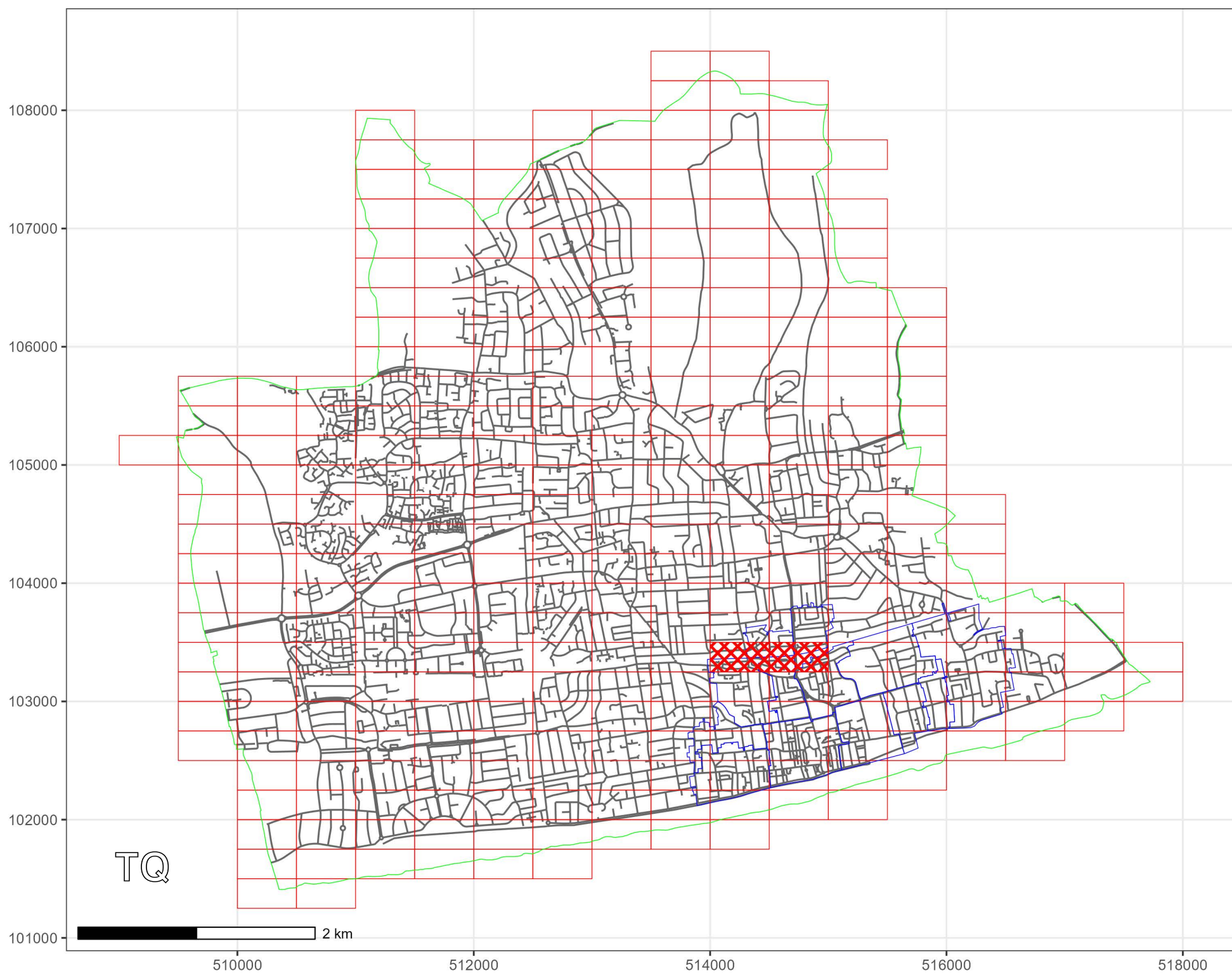





WEST SUSSEX COUNTY COUNCIL
((WORTHING)(PARKING PLACES & TRAFFIC REGULATION)
(CONSOLIDATION) ORDER 2007)
(RAILWAY APPROACH AND VICTORIA ROAD AMENDMENT)
ORDER 2024

WORTHING: LOCATION OF WAITING RESTRICTIONS



KEY:

-  OS.TILE GRID
-  PARKING TILE GRID
-  LOCATION OF WAITING RESTRICTIONS
-  PARISH BOUNDARY
-  ROAD NETWORK
-  CONTROLLED PARKING ZONE BOUNDARY



West Sussex County Council
 Highways & Transport
 The Grange
 Tower Street
 Chichester
 West Sussex
 PO19 1RH

WEST SUSSEX COUNTY COUNCIL
 ((WORTHING)(PARKING PLACES & TRAFFIC REGULATION)
 (CONSOLIDATION) ORDER 2007)
 (RAILWAY APPROACH AND VICTORIA ROAD AMENDMENT)
 ORDER 2024







LOCATION OF WAITING RESTRICTIONS



Key for Waiting Restrictions

All areas over which the provision of the orders apply are defined by the shaded areas as shown on the following plans plus a contiguous area not indicated on the plans of verge and/or footway between the carriageway edge and the highway boundary. The plans in this schedule are based upon grid references of the Ordnance Survey National Grid defined by the OSGB 36 triangulation.

Prohibition of Waiting

100		z_circle	No waiting, loading and unloading at any time
101		check	No waiting at any time
108		pat 038	No waiting 8.30am-6.00pm Mon-Sat
155		pat 038	No waiting 8.30am-6.00pm Mon-Sat except bank holidays
156		pat039	No waiting 9.00am-6.00pm Mon-Sat except bank holidays
181		usgs721	No waiting 10.00am-11.00am, 2.00pm-3.00pm Mon-Sat except bank holidays

Shared Residents Parking & Charged On-street Parking

413		pat038	Pay and Display up to 2hrs and Residents' and Visitors' permit holders 9.00am-6.00pm Mon-Sat except bank holidays
-----	---	--------	---

Shared Residents Parking & Free Limited Waiting

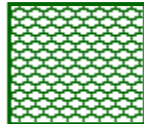
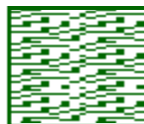
613		usgs503	Residents' and Visitors' permit holders and Limited waiting for 2hrs No return within 2 hours for non-permit holders 9.00am-6.00pm Mon-Sat except bank holidays
614		pat019	Residents' and Visitors' permit holders and Limited waiting for 2hrs No return within 2hrs for non-permit holders 9.00am-5.00pm Mon-Sat except bank holidays

Free Limited Waiting

714		pat064	Waiting limited to 1hr No return within 1hr 8.30am-6.00pm Mon-Sat
732		usgs725	Waiting limited to 2hrs No return within 2hrs 9.00am-6.00pm Mon-Sat except bank holidays
733		usgs721	Waiting limited to 1hr No return within 1hr 9.00am-6.00pm. Mon-Sat except bank holidays
762		usgs724	Waiting limited to 20mins No return within 40mins at any time

Specified Vehicles

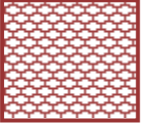
810  usgs503 Loading bay-Goods vehicles only at any time

830  check Disabled persons vehicles at any time

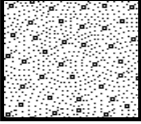
845  usgs602 No waiting at any time except taxis

Clearways

1103  herring3 Bus stop Clearway-No stopping except buses at any time

WEST SUSSEX COUNTY COUNCIL
((WORTHING) (PARKING PLACES & TRAFFIC REGULATION) (CONSOLIDATION)
ORDER 2007)

(RAILWAY APPROACH AND VICTORIA ROAD AMENDMENT) ORDER 2024

West Sussex County Council in exercise of their powers under Sections 1 (a) 2 (1) and (2), 4 (2), 45. 46. 49 and 53 and Part IV of Schedule 9 of the Road Traffic Regulation Act 1984 ("the Act") as amended and of all other enabling powers and after consultation with the Chief Officer of Police in accordance with Part III of Schedule 9 to the Act hereby make the following Order:-

1. The Order shall come into operation on the Sixteenth day of December 2024 and may be cited as "West Sussex County Council ((Worthing) (Parking Places & Traffic Regulation) (Consolidation) Order 2007) (Railway Approach and Victoria Road Amendment) Order 2024".
2. The "West Sussex County Council (Worthing) (Parking Places & Traffic Regulation) (Consolidation) Order 2007" is hereby amended by the replacement of the plans specified in the First Schedule to this Order, with the plans specified in the Second Schedule, attached hereto.
3. The Second Schedule of the "West Sussex County Council (Worthing) (Parking Places & Traffic Regulation) (Consolidation) Order 2007" as amended by any subsequent Orders, is hereby amended by the addition of "Railway Approach" to the section of the schedule specifying roads within the "Low Cost Outer P&D Zone".

FIRST SCHEDULE
Plans to be Replaced

TQ1403SEN (Issue Number 7)
TQ1403SWN (Issue Number 7)

SECOND SCHEDULE
Replacement Plans

TQ1403SEN (Issue Number 8)
TQ1403SWN (Issue Number 8)

For and on behalf of WEST SUSSEX COUNTY COUNCIL

Authorised Signatory:



NAME: Martin Moore

DATE MADE: Twelfth day of December 2024

WOR8020-MM

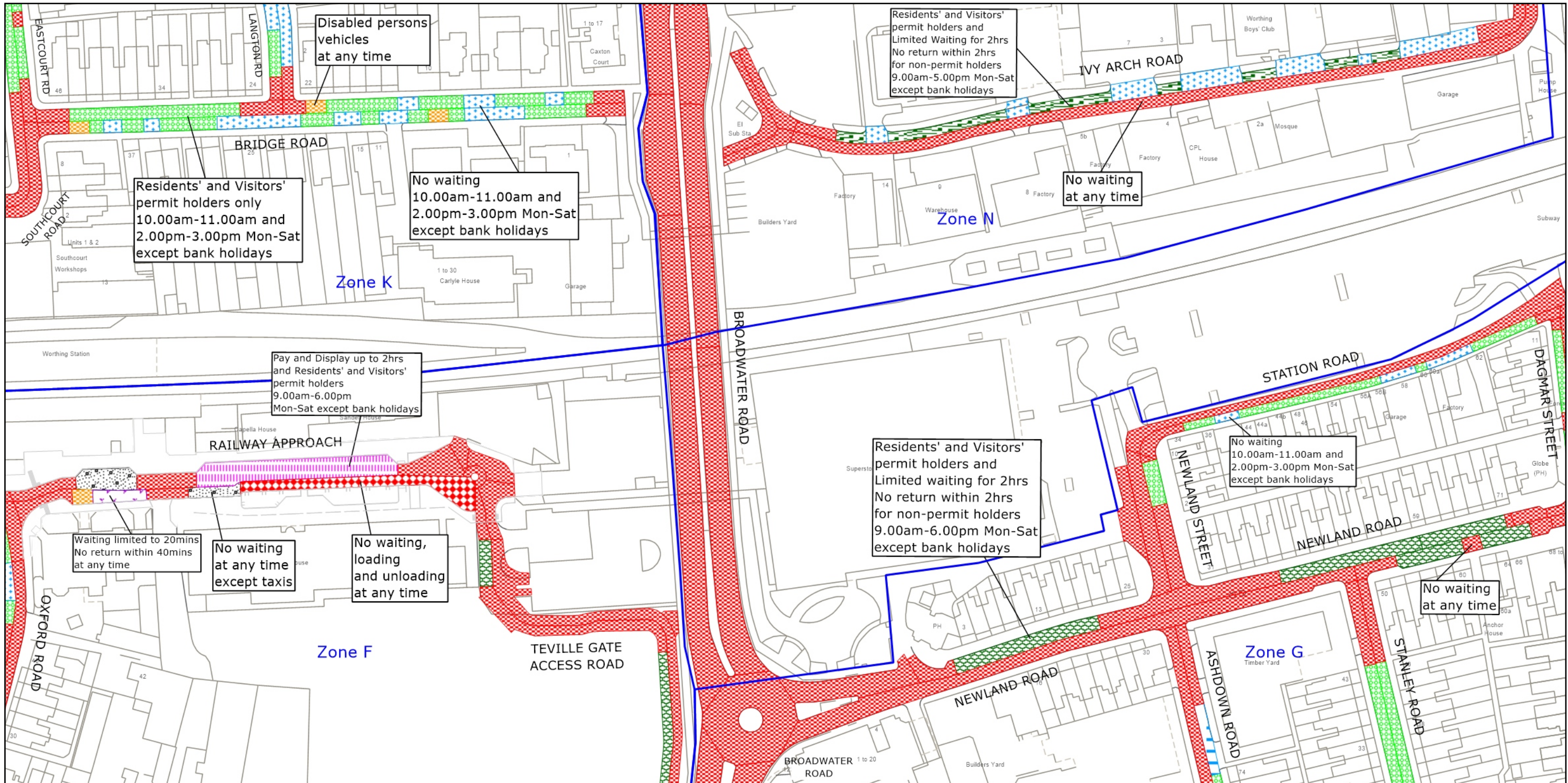

West Sussex County Council
 Highways & Transport
 The Grange
 Tower Street
 Chichester
 West Sussex
 PO19 1RH

WORTHING BOROUGH: BROADWATER, CENTRAL AND GAISFORD WARDS

WAITING RESTRICTIONS

TILE REF NO:
 TQ1403SEN

SHEET ISSUE NO 8
 SHEET ACTIVE FROM - 16.12.2024



SCALE:
 1:1250
 at A3 size

© Crown copyright and database rights 2025 OS AC0000849983. You are permitted to use this data solely to enable you to respond to, or interact with, the organisation that provided you with the data. You are not permitted to copy, sub-license, distribute or sell any of this data to third parties in any form.

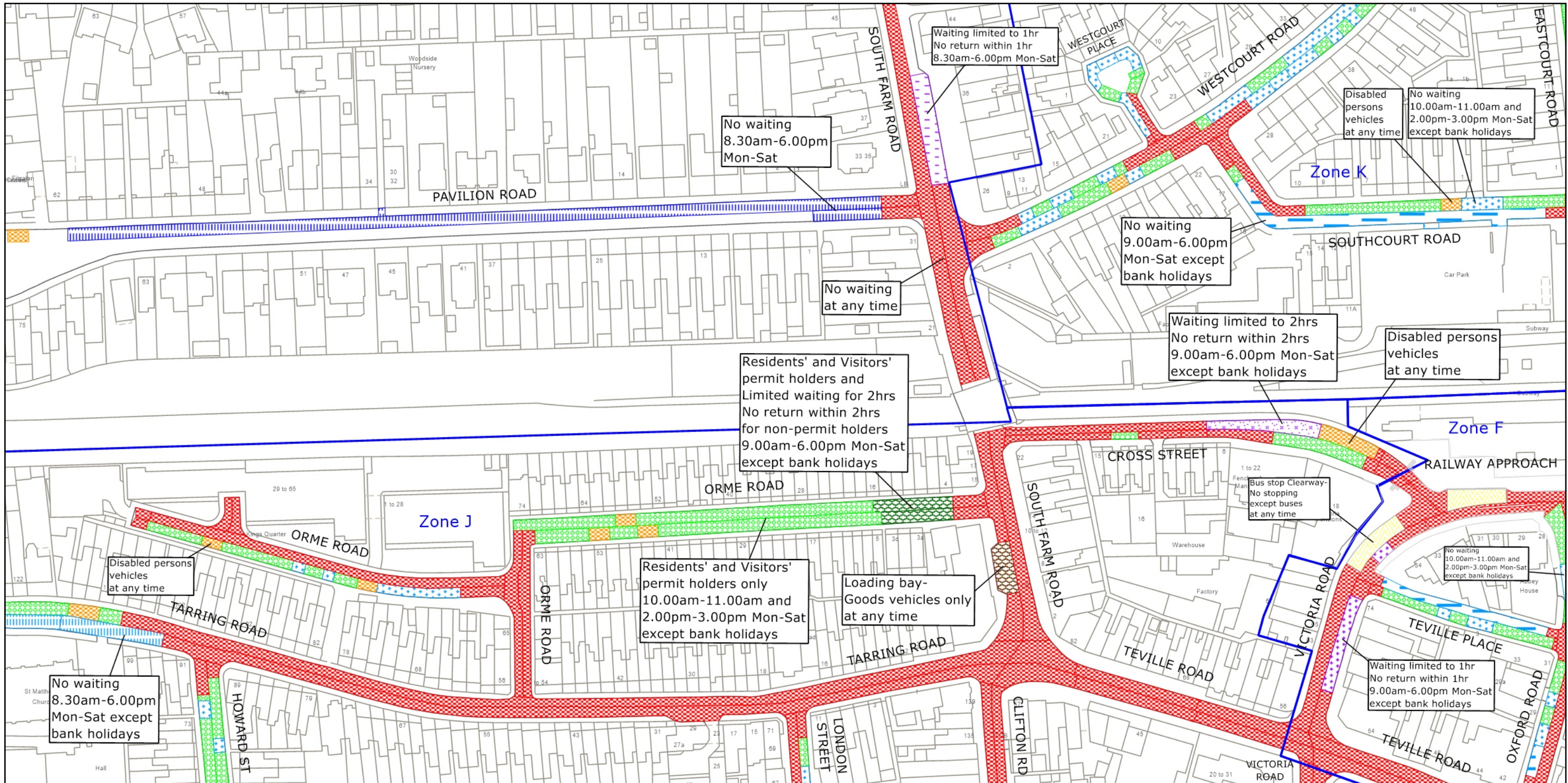

West Sussex County Council
 Highways & Transport
 The Grange
 Tower Street
 Chichester
 West Sussex
 PO19 1RH

WORTHING BOROUGH: CENTRAL AND GAISFORD WARDS
 WAITING RESTRICTIONS

TILE REF NO:
 TQ1403SWN
 SHEET ISSUE NO 8
 SHEET ACTIVE FROM - 16.12.2024

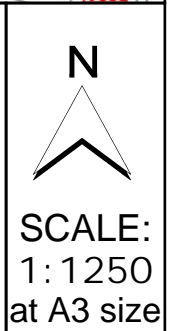

© Crown copyright and database rights 2025 OS AC0000849983. You are permitted to use this data solely to enable you to respond to, or interact with, the organisation that provided you with the data. You are not permitted to copy, sub-license, distribute or sell any of this data to third parties in any form.